

POCKET PROGRAM



NATIONAL ALLIED HEALTH CONFERENCE

11TH NAHC CONFERENCE | 9-11 NOVEMBER 2015
CROWN CONFERENCE CENTRE, MELBOURNE

HOSTS

SPONSORS



Partner Sponsor



Silver Sponsors



S·A·R·R·A·H
Services for Australian
Rural and Remote Allied Health



Queensland
Government



Name Badge Sponsors



S·A·R·R·A·H
Services for Australian
Rural and Remote Allied Health

PROGRAM

Monday 9 November 2015

1600-1900	Conference Registration	Open Ground Level (outside Exhibition Hall)
1600-1800	Speaker's Preparation Room Open	Level 1 PCO Suite
1730-1930	Welcome Reception	Ground Level, Exhibition Hall

Tuesday 10 November 2015

0700-1700	Conference Registration Open	Ground Level (outside Exhibition Hall)
0700-1700	Speaker's Preparation Room Open	Level 1 PCO Suite
0730-0830	Arrival Tea & Coffee	Ground Level, Exhibition Hall
	Opening Plenary Chair: Kathleen Philip, Chief Allied Health Advisor (Victoria)	Level 2, Conference Hall
0830-0900	Welcome to Country: Aunty Carolyn Briggs, Elder of the Boon Wurrung People Welcome Address: Minister for Health, The Hon. Jill Hennessy MP, VIC	
0900-0950	Keynote Speaker: Professor Mary Lovegrove OBE, London South Bank University <i>Allied health realising the potential</i>	
0950-1040	Keynote Speaker: Holly Ransom, Young Australian of the Year 2013 finalist, CEO of Emergent Solutions <i>Intergenerational leadership – inspiring change</i>	
1040-1120	Morning Tea & Poster viewing	Ground Level, Exhibition Hall

Concurrent Session 1

Room	CCH 1 – LEVEL 2	CCH 2 – LEVEL 2	CCH 3 – LEVEL 2
Theme Track	Research & quality improvement: It works better this way	Infinity & beyond...extending the scope of practice	Education: Learning together to enhance skills in allied health
Chairs	Rosalie Boyce	Susan Nancarrow Stephen Duns	Terry Haines Elizabeth Skinner
1120-1150	<i>Key research support staff and location influences the research capacity and culture of the Victorian public health allied health workforce</i> Dr Cylie Williams	<i>Key performance indicators to measure expanded scope of practice</i> Andrea Hurwood, Liza-Jane McBride	<i>Inter-professional simulated education: Evaluating a diabetes simulation with students from nutrition and dietetics and exercise physiology</i> Nathan Reeves
1150-1155	5 minute transition time		
1155-1210	<i>Integrating the knowledge into action framework with a project management model to drive service improvement initiatives</i> Jill Mahoney	<i>Complementary physical therapies for movement disorders in Parkinson's disease: A systematic review</i> Meg Morris	<i>Transitioning Allied Health into the digital world of a new quaternary hospital - an educators perspective</i> Khye Davey
1210-1225	<i>Songwriting to explore self-concept following acquired neurological injury</i> Dr Jeanette Tamplin	<i>The impact of a physiotherapist led paediatric fracture clinic. Sharing the load of outpatient fracture care</i> Mark Napper	<i>Preparing physiotherapy students for clinical placement: Student perceptions of peer-simulation</i> Narelle Dalwood
1225-1230	5 minute transition time		
1230-1245	<i>Dietetic intervention for inpatients on fluid diets helps to achieve nutritional requirements</i> Shonnel Rothery	<i>Expanding extended scope of practice for dietitians in the management of gastrostomy tubes and cares</i> Claire Blake	<i>Effectiveness of clinical supervision of allied health professionals: A survey</i> David Snowdon
1245-1300	<i>Increasing allied health research output - leading a strategy</i> Lyndell Keating	<i>Allied health collaboratives facilitate accelerated implementation of expanded scope models of care</i> Liza-Jane McBride	<i>Supporting health professionals emotional reactions to grief and loss</i> Anthea Udovich
1300-1400	Lunch & Poster viewing		

M11 – LEVEL 1	M12 – LEVEL 1	M13 – LEVEL 1	M14 – LEVEL 1
Effective use of the allied health assistant workforce	Models of care in allied health	Innovation in professional development	Workforce development: Tomorrow's stars
Leah Wiseman Peter Nuttman	Jacinta Russell Michele Smith-Tamaray	Genevieve Napper Kerry May	Bill Suen Marg Sherburn
<i>Development of simulated learning resources for allied health assistants training</i> Lee McGovern	<i>West foot forward - outcomes of a high risk diabetes foot service</i> Julia Firth	<i>Development of a competency framework: Physiotherapists' perceptions of workplace knowledge and skills</i> Rodney Sturt	<i>Austin Health Physiotherapy workforce redesign</i> A/Prof Sue Berney, Debbie Munro
<i>Creation and evaluation of an AHA Care Coordination model in regional Victoria</i> Annalee Gardam, Kylie Murphy, Samantha Coonan	<i>Generalized compared to disease-specific outpatient rehabilitation in people with multimorbidity: Feasibility outcomes from a pilot randomized controlled trial</i> Kathryn Barker	<i>The Allied Health infant and family discharge program</i> Cara Naughton	<i>Occupational therapists' experiences of career progression following promotion</i> Susan Giles
<i>Allied Health assistant model: towards patient based care</i> Rachel De Monte	<i>Challenging the Monday to Friday workforce - evaluation of an innovative seven day occupational therapy and physiotherapy service in the acute setting</i> Jude Boyd	<i>An exploratory study on facilitation of reflective practice skills for Grade 1 Occupational Therapy clinicians</i> Lauren Guy	<i>Ensuring quality documentation practice - a review of allied health practice</i> Jo Brady
<i>Team training improves delegation practices</i> Laura Morrison	<i>Establishing a nutrition-led, multidisciplinary parenteral nutrition round</i> Fiona Rezannah	<i>Advanced scope of practice social work: A model of care for paediatric and maternity trauma at Sunshine Hospital</i> Nicole Lind	<i>Creating workforce agility: Right task, right worker</i> Kathleen Philip
<i>tASK app to support delegation to allied health assistants</i> Annette Davis, Anton Glagovski	<i>A new model of care - a study proposal for the implementation and evaluation of the Allied Health Interdisciplinary Practitioner (AHIP)</i> Nicholas Ternes	<i>Key elements of effective supervision for physiotherapists</i> Fiona Brennan	<i>Supervision skills training - outcomes from a state-wide program in Victoria</i> Emma Scott

Ground Level, Exhibition Hall

Concurrent Session 2

Room	CCH 1 – LEVEL 2	CCH 2 – LEVEL 2	CCH 3 – LEVEL 2
Theme Track	Heads up: The evidence for allied health roles of the future	Professional development front & centre	Advancing extended scope of practice
Chairs	Michele Smith-Tamaray Kathleen Philip	Jackie Martin-Kerry Bill Suen	Marg Sherburn Susan Nancarrow
1400-1415	<i>Effectiveness of weekend allied health services on acute medical/surgical wards: Two randomised controlled trials</i> Prof Terry Haines	<i>Stepping into research: An Allied Health research training scheme</i> Prof Nick Taylor	<i>Mixed methods evaluation of a comprehensive osteoarthritis hip and knee service: Patient, clinician and administrative perspectives</i> Bernarda Cavka
1415-1430			
1430-1435	5 minute transition time		
1435-1450	<i>The Barwon Health Temporomandibular Joint (TMJ) Physiotherapy Clinic - advanced practice physiotherapy in the Department of Oral Health. A pilot project</i> Kara Hanson	<i>Changing our ways: Developing an advanced practice role for dietitians</i> Belinda Steer	<i>Advanced practice mapping and prioritisation tool</i> Sam Sevenhuysen
1450-1505	<i>The effect of increasing audiology services for patients referred to an ENT Department</i> Lee Kethel	<i>Development, implementation and evaluation of clinical supervision e-learning courses: A South Australian experience</i> Kate Osborn	<i>The wait is over: Early health care delivery for acquired hand conditions</i> Zoe Milner, Susie Ellis, Kelly Briody, Fiona Moate
1505-1510	5 minute transition time		
1510-1525	<i>With an eye to the future: Working together for a more comprehensive holistic service</i> Jonathon Jackson	<i>Evaluating occupational therapist's views and perceptions of professional self-care</i> Courtney Apostol	<i>Untapping the potential of advanced musculoskeletal physiotherapy</i> Paula Harding

M11 – LEVEL 1	M12 – LEVEL 1	M13 – LEVEL 1	M14 – LEVEL 1
Rural health innovations	Allied health careers & student/graduate projects	Research & quality improvement projects	High performing teams: Utilising allied health assistants
Helen McBurney Petra Boverly-Spencer	Kerry May Olivia Rofe	Peter Nuttman Nicole Turner	Annette Davis Leah Wiseman
<i>A shift in focus from rural workforce to service provision</i> Dr Robyn Adams	<i>Bonded schemes: What do allied students think?</i> Ruth McLeod	<i>Hospital Inpatient versus Home-based rehabilitation after knee arthroplasty (the HIHO study): Preliminary results of a randomised controlled trial</i> Mark Buhagiar	<i>Speech Pathology Occupational Therapy (SPOT) Allied Health assistant: A patient flow initiative</i> Brooke Cowie
<i>A private, multidisciplinary, interstate, rural and remote Allied Health organisation: How do they manage?</i> Melissa Johnstone			
<i>Rural remote generalist clinical requirements of allied health professions in Northern Australia</i> Rena Moore, Ilsa Nielsen	<i>Allied health clinical training patterns in Victoria</i> Sam Green	<i>A Podiatry service for homeless people: an audit of an assertive outreach podiatry service</i> Leanna Helquist	<i>Extended scope models of allied health assistant practice & the impact of organisational culture</i> Sharon Downie
<i>The evolution of a rural team - advancing individuals and our service utilising rural development positions</i> Lisa Baker, Amy Gray, Rachel Pennisi	<i>Can a culture change make aged care a more attractive rotation for junior physiotherapy staff?</i> Jacqueline Kay	<i>Health services research in a tertiary hospital setting: Can Allied Health clinicians adhere to the protocol to ensure research fidelity</i> Dr Kelly-Ann Bowles	<i>An innovative approach to the implementation of training and development for Allied Health Assistants in the South Island of New Zealand</i> Randa Abbasi, Catherine Coups
<i>Allied Health front and centre in a regional critical care unit - a case study</i> Dr Brooke Winzer, Sally Wilson	<i>Using the Calderdale Framework to safely enhance the development of efficient and patient centred clinical education models</i> Linda Furness	<i>The business end of service delivery: Challenges of moving toward a fee for service therapy model</i> Rebekah Cranmer, Janelle Johanson	<i>Changing Roles for Dietetic Allied Health Assistants - 2011 vs 2015</i> Denise Cruickshank

1525-1540		<i>Early intervention for lymphoedema - changing allied health practice through education</i> Sue Steele-Smith	<i>Screen time: Physiotherapist-led orthopaedic lower limb screening clinic</i> David O'Keefe
1540-1610	Afternoon Tea & Poster viewing		
	Plenary Chair: Julie Hulcombe, Chief Allied Health Advisor (Queensland); Chair of National Allied Health Advisory Council		
1610-1615	Chair introduction		
1615-1700	Plenary Speaker: Mark McCrindle, Social researcher/demographer/trends analyst, McCrindle Research <i>Changing times, transitioning communities: Understanding the megatrends transforming the future of Allied Health</i>		
1830 till late	Conference Dinner featuring HESTA Primary Healthcare Awards		

Wednesday 11 November 2015

0700-1500	Conference Registration Open
0700-1500	Speaker's Preparation Room Open
0740-0840	Arrival Tea & Coffee

Concurrent Session 3

Room	CCH 1 – LEVEL 2	CCH 2 – LEVEL 2	CCH 3 – LEVEL 2
Theme Track	Big ideas: Future vision for allied health	Healthcare - the right patient, place & cost	Preparing a new generation
Chairs	David Meade Terry Haines	Nicole Turner Debbie Schulz	Stephen Duns Helen McBurney
0840-0910	<i>Reducing cancer malnutrition through collaboration: Phase II state-wide malnutrition projects in Victorian cancer services</i> Jenelle Loeliger, Dr Nicole Kiss	<i>Are physiotherapy screening clinics cost effective in addressing unmet demand in orthopaedic outpatients?</i> Maree Raymer	<i>Minimum standards of clinical practice for physiotherapists working in Australian and New Zealand critical care settings: A modified Delphi technique</i> Dr Elizabeth Skinner

Facilitating allied health lymphoedema services using distance education, coaching and technology in rural and remote areas of Queensland
Fiona Hall

Assessing student and supervisor satisfaction of Clinical Nutrition placements
Lauren Grundy

Evidence-based clinical assessment - evaluating, selecting and using clinical assessments in paediatric occupational therapy: An organisational approach to quality, translation and implementation
Dr Bess Fowler

Knowledge, experience and training needs for independent allied health assistant practice
Jacqueline Salway

**Ground Level, Exhibition Hall
Level 2, Conference Hall**

Plaza Ballroom, 191 Collins Street

**Ground Level (outside Exhibition Hall)
Level 1 PCO Suite**

Ground Level, Exhibition Hall

M11 – LEVEL 1	M12 – LEVEL 1	M13 – LEVEL 1	M14 – LEVEL 1
Advanced technology & future applications in health & practice	Collaborative health & practice	New horizons for models of care	Better care through audit & research
Pazit Levinger Elizabeth Skinner	Jacinta Russell	Kelly-Ann Bowles Leah Wiseman	Jackie Martin-Kerry Mathew Jenkins
<i>The hand hub: Using technology for upper limb rehabilitation</i> Marlena Klaic	<i>A multidisciplinary approach to assessment in disorders of consciousness</i> Claire Collins, Robert Thorniley	<i>Specific Timely Appointments for Triage (STAT) Reduced waiting lists in an outpatient physiotherapy service</i> Dr Katherine Harding	<i>Not enough time for research? The use of a supported short-term clinical backfill initiative in promoting local research capacity of allied health professionals</i> Dr Rachel Wenke

0910-0925	<i>HeLP - a partnership between social workers and lawyers, improving patient outcomes and health</i> Bridget Wall	<i>Missing Voices: Aboriginal stories of stroke and traumatic brain injury</i> Meaghan McAllister	<i>Indicators for effective oncology social work practice: an international audit</i> A/Prof Christa Fouche
0925-0930	5 minute transition time		
0930-0945	<i>Gaps in support services for people with chronic post-stroke aphasia- suggested solutions</i> A/Prof Miranda Rose	<i>Closing the gap - system redesigning to ensure all Aboriginal and Torres Strait Islander patients are supported in their journey with Peninsula Health</i> Craig Wotherspoon	<i>Psychology staffing in Australian metropolitan acute public hospitals</i> Kathryn Collins, Anne Burke
0945-1000	<i>Diversity of thinking to elicit culture change within subacute care</i> Laura Pennisi	<i>A blueprint for equity - the Western NSW Local Health District allied health resource</i> Angela Firth	<i>How to keep staff motivated, engaged and moving up the career ladder: Can Step Up help?</i> Amy Haantjens
1000-1005	5 minute transition time		
1005-1020	<i>Live music to promote patient, visitor and staff wellbeing in an adult oncology hospital</i> Anneliis Way	<i>Be deadly, get healthy - An opportunity for exercise in the Aboriginal community</i> Kristy Doughney	<i>Grade two occupational therapy rotations: Service delivery impact and clinician perspectives</i> Anna Joy
1020-1035	<i>'The customer is always right' - The lived experience of community project implementation</i> David Towl, Fiona Mckinnon	<i>Allied Health specialist outpatient clinics: Using data to ensure survival</i> Michelle Stute	<i>How much Allied Health is enough-using clinical care ratios for workforce planning and workload monitoring for allied health professionals</i> Cherie Hearn
1035-1105	Morning Tea & Poster viewing		

<p><i>Preparing for medical imaging - there's an app for that!</i> Siobhan Greene</p>	<p><i>Implementation of a Joint Occupational Therapy (OT) and Physiotherapy (PT) Upper Limb (UL) Assessment Form for Neurological Clients Treated in the Community Setting</i> Trinh Vo, Josie Weightman</p>	<p><i>Food for thought: A novel psychological and non-dieting approach to weight management</i> Georgia Rossetto</p>	<p><i>Improving documentation and coding of malnutrition - a five year journey</i> Natalie Simmance</p>
<p><i>Addressing antibiotic resistance in regional Victoria using telecommunication consultation</i> Neeva Maskey</p>	<p><i>Sensory based interventions: Allied health leadership and clinical expertise guided organisational inter-disciplinary practice and promoted allied health discipline specific skills</i> Heather Davey, Elizabeth Scutt</p>	<p><i>Validation of clinical task instructions (competencies) to support expanded scope and delegation practice</i> Ilsa Nielsen, A/Prof Alison Pighills</p>	<p><i>A systematic review of core stability training for ambulant people with Multiple Sclerosis</i> Priya Rangarajan</p>
<p><i>Using innovative 3D scanner technology to improve the supply of customised footwear to clients in country South Australia</i> Fiona Murray, Claire Easterbrook</p>	<p><i>Driving from the start - collaborative learning and practice in a new hospital</i> Sue Alexander</p>	<p><i>Feed not fast: Improving patient satisfaction and outcomes with a change in dietetic model of care</i> Sally Courtice</p>	<p><i>Study of allied health EBP capacity - a re-assessment of self-efficacy, outcome-expectancy in, and use of EBP</i> Dr Shelley Wilkinson</p>
<p><i>Optimising multidisciplinary triage of head and neck cancer patients and their carers during chemoradiotherapy using technology: the 'ScreenIT' system</i> Laurelie Wall</p>	<p><i>Social work and interdisciplinary practice: Evidence from a multi-site audit</i> Glenda Kerridge</p>	<p><i>Back to BAC: Lessons learnt from developing, implementing and evaluating a novel, collaborative, physiotherapy-led multidisciplinary Back pain Assessment Clinic (BAC) in primary care</i> Uyen Phan</p>	<p><i>HIP4Hips: High intensity physiotherapy following hip fracture surgery is safe and effective in reducing hospital length of stay</i> Lara Kimmel</p>
<p><i>Designing technology for Allied Health assessments of patients from CALD backgrounds</i> Courtney Pocock</p>	<p><i>Delivering advance care planning at residential aged care facilities - the right care at the right place, at the right time</i> Pamela deKlerk</p>	<p><i>Allied Health general medicine model of care project</i> Elizabeth Batchelor</p>	<p><i>An investigation into student contribution to physiotherapy clinical services within Queensland Health</i> Kassie Shardlow, Mark Goodin</p>

Ground Level, Exhibition Hall

	Plenary Sessions Chair: Vittorio Cintio, Chief Allied Health Officer (New South Wales), Workforce Planning & Development		
1105-1110	Welcome & housekeeping		
1110-1155	Keynote Speaker: Kym Peake, Acting Secretary, Department Health and Human Services <i>Allied Health: The broader context</i>		
1155-1245	Keynote Speaker: Jason Clarke, Minds at Work <i>Step back, step up</i>		
1245-1345	Lunch & Poster Presentation Session (1300-1330 M11)		
Poster Presentation Session (3 minutes + 2 minutes questions) Chairs: Marg Sherburn, Jacinta Russell			
1300-1305	<i>Evaluation of the 'Enhancing the role of the Nutrition Assistant at Dandenong Hospital' Project</i> Teresa Orsini		
1305-1310	<i>Providing shared client care across organisations: Tools to implement the AHA Supervision and Delegation Framework</i> Deborah Kay		
1310-1315	<i>Developing the role of Speech Pathology in palliative & supportive care</i> Thomas Gauci		
1315-1320	<i>Developing the validated Foot-Care Abilities Questionnaire (F-CAQ), using quality improvement outcomes</i> Tina Loxley		
1320-1325	<i>Does eating environment have an effect on the intake in the elderly</i> Aurora Ottaway		
1325-1330	<i>Use of a decision support software (Guidance MS) to guide prescribing of new oral anticoagulants (NOAC)</i> Vinod Chellaram		
Concurrent Session 4			
Room	CCH 1 – LEVEL 2	CCH 2 – LEVEL 2	CCH 3 – LEVEL 2
Theme Track	Working beyond the normal expectations - Allied Health	Allied health marketing & profile	Innovation, quality improvements, research... & more
Chairs	Kathleen Philip Peter Nuttman	Debbie Schulz Rosalie Boyce	Elizabeth Skinner Genevieve Napper
1345-1415	<i>Bridging allied health roles for better patient outcomes. An authorising mechanism to enable practitioners to reach and practice across clinical domains</i> Brenda Wraight	<i>The 'true' value of Allied Health</i> Natasha Toohey	<i>Evaluating radiation therapy care coordination at the Royal Brisbane and Women's Hospital (RBWH) - how prepared are patients for radiation planning and treatment?</i> Kathryn Vidler
1415-1430	<i>Development of a credentialing package to support the introduction of advanced practice hand therapy roles</i> Nicole Byrne, Elizabeth Witherow	<i>Allied Health: Front and centre in social media?</i> Julia-Anne Ross	<i>The resource allocation decision tool (ReAD-iT): Development of items for a web-based instrument to aid evidence-based resource allocation in health care</i> Tamica Sturgess

M11 – LEVEL 1	M12 – LEVEL 1	M13 – LEVEL 1	M14 – LEVEL 1
Innovations in delivery of care	Education & academics in allied health	Prescribing in allied health	Preparing the next generation of health care professionals
Helen McBurney Michele Smith-Tamaray	Petra Boverly-Spencer David Meade	Olivia Rofe Kerry May	Catherine Stephens Kelly-Ann Bowles
<i>Improving patient access: Outcomes from an Allied Health Cancer Care Redesign Project</i> Dr Desley Harvey, Ilsa Nielson	<i>Emotional intelligence: A critical competency for therapy students undertaking clinical placements</i> Nigel Gribble	<i>Australia's first Allied Health prescribing program - exploring participants' perspective on the study program's learning objectives</i> Josephine Martelli, Marea Patounas	<i>Developing collaborative partnerships between hospital and local gym facilities to successfully facilitate long-term self-management</i> Lauren Farrugia
<i>Paediatric outpatient models of care - advanced Health Practitioner</i> Julie Creen, Kellee Gee	<i>The Interprofessional Learning Outcomes Scale (IpLOS): An alternative instrument for measuring outcomes of interprofessional education</i> Matthew Oates	<i>Review of the prescribing capability of speech pathologists, dietitians and psychologists</i> Karen Bettenay	<i>Development of an Allied Health rural generalist pathway</i> Vanessa Burge

1430-1435	5 minute transition time		
1435-1450	<i>Supporting person-centred decision making: Application for service provision and resource allocation</i> Dr Rachel Schmidt	<i>Defining Allied Health: Through multi-level engagement</i> Prof Sharon Mickan	<i>The sticker sticks for malnutrition identification and coding</i> Jenna Stonestreet
1450-1505	<i>Hand therapy led clinics - first point of contact management following hand surgery</i> Stephanie Tawse		<i>The design, implementation and evaluation of a new clinical governance framework for an Allied Health directorate</i> Kate Roberts
1505-1520	<i>Acceptance of Primary Contact Physiotherapy by ED staff - results of a qualitative study</i> Stephen Gill	<i>Contemporary Allied Health practice - lessons from IKEA</i> Bronwyn Venning	<i>Music-assisted relaxation during transition to non-invasive ventilation in people with motor neuron disease</i> Eleanor Bajo, Rebecca Davies
1520-1545	Afternoon Tea & Poster viewing		
	Closing Plenary Chair: Kathleen Philip, Chief Allied Health Advisor (Victoria)		
1545-1645	Plenary Panel: AH front and centre - Are we there? Mark Cormack, Debra Kay, Dale Fisher, Professor Mary Lovegrove, Associate Professor Jonathon Jackson		
1645-1705	Awards & Prizes		
1705-1715	Conference Handover & Close		

Thursday 12 November 2015

0800	Registration open - These workshops are fully subscribed.
0900-1100	Mark Cormack, the National Chief Allied Health Officer and Deputy Secretary <i>The vision for allied health in primary health</i>
1100-1130	Morning Tea
1130-1330	Professor Mary Lovegrove OBE & Professor Susan Nancarrow <i>International Network for Allied Health Leaders: An Appreciative Thinking Event</i>

<p><i>Analysis of the effect of changes to Speech Pathology service delivery methods on stroke client's outcomes using AustOMs: exploring the challenges</i> Lauren Ranalli</p>	<p><i>A mixed methods research approach to the review of competency standards for orthotist/prosthetists in Australia</i> Leigh Clarke</p>	<p><i>Assessment of prescribing in health (the ASPRINH Project): how should we ensure health professionals are prescribe-ready?</i> Lynda Cardiff</p>	<p><i>Harnessing employee engagement in an Allied Health department: Moving from a culture of blame to a culture of success</i> Amy Bach</p>
<p><i>Early commencement of therapy in the acute phase following elective lower limb arthroplasty produces favourable outcomes: A systematic review and meta-analysis</i> Romi Haas</p>			<p><i>Establishment, implementation and sustainability of the Western Health Allied Health and Community Services Clinical Governance Framework</i> Claire Moody</p>
<p><i>Evaluation of a pilot project to increase access to Allied Health services in four rural communities in South West Victoria</i> Lyndall McNeil</p>	<p><i>Building capacity of Allied Health professionals to care for the dying: Achievements and lessons from the Palliative Care Curriculum for Undergraduates project</i> Kylie Ash</p>	<p><i>Partnered medication charting model: Clinical pharmacist and medical officer in the Emergency Short Stay and General Medicine Unit</i> Erica Tong</p>	<p><i>The real cost of training health professionals in Victoria</i> Claire Marsh</p>

**Ground Level, Exhibition Hall
Level 2, Conference Hall**

Panel Chair: Marcus Dripps, National President of the Australian Physiotherapy Association

Level 1, Room M11

Level 1, Room M11

ePOSTERS

THEME	Allied Health Marketing and Profile
1	<i>The importance of blogging in healthcare: Experience from an OT practice</i> Amy Geach
2	<i>Preventing pitfalls of service planning through early engagement of allied health</i> Julianne Donnelly*, Sarah Raffell
3	<i>What GPs want!</i> Amy Geach
4	<i>Disposal of unwanted medications: A safer home for the elderly</i> Kyrillos Guirguis
5	<i>E-learning resource to support allied health assistant delegation training</i> Annette Davis, Tilly Waite, Desiree Terrill
THEME	Assistant Workforces
6	<i>A day in the life of an Interdisciplinary Allied Health Assistant</i> Rosie Antypas*, Dr Lisa O'Brien, Jacqui Salway
7	<i>Allied health assistances in cardiorespiratory and paediatrics physiotherapy</i> Cassie Bell
8	<i>Providing shared client care across organisations: Tools to implement the AHA Supervision and Delegation Framework</i> Dr Suzanne Evas, Vicki Jenkins, Ashley Willock, Deborah Kay*
9	<i>Evaluation of speech pathology therapy assistant roles in an acute stroke unit</i> Aditi Gandhi, Marissa Corcoran, Rachel Wenke*
10	<i>Evaluation of the 'Enhancing the role of the Nutrition Assistant at Dandenong Hospital' project</i> Teresa Orsini*, Jennifer Sequiera, Celia Durie

11	<i>National Allied Health Assistant Working Group: A community of practice</i> Leanne Pagett
12	<i>Introduction of Community Care Allied Health Assistant Clinics</i> Leanne Pagett*, Dominic Furphy, Shaun Archer
13	<i>Using the Calderdale Framework for workforce redesign: Pharmacy Assistant role redesign on an inpatient unit</i> Rachael Raleigh, Trudy Teasdale, Jill Mahoney*, Dr Rachel Wenke
14	<i>The development and implementation of a mealtime assistance competency program for allied health assistants</i> Dr Amanda Scott*, Meaghan Waddingham, Janine Mahoney, Dr Delwyne Stephens
15	<i>Allied health assistants in NSW - a structured approach</i> Sue Steele-Smith
16	<i>Allied Health Assistant training program for equipment sourcing and ordering</i> Sarah Temby, Bernadette O'Connor*, Erin Lowrie
17	<i>The role of Physician Assistants in Allied Health Workforce in rural Australia</i> Ankur Verma, Ruth Mcleod*
THEME	Big Ideas
18	<i>Clinical prioritisation tools - to use or not to use?</i> Jo Brady*, Katherine Harding
19	<i>Professionalism and philosophy: Understanding workforce change</i> Martin Chadwick
20	<i>Improving allied health and nursing outcomes through best practice guidelines for Duchenne muscular dystrophy</i> Dr Zoe Davidson*, Dr Paula Bray, A/Prof. Monique Ryan, Merryn Pearce, Prof. Joshua Burns
21	<i>From little things, big things grow - the development of an infant feeding system</i> Kay Gibbons*, Bernadette O'Connor, Michele Meehan

22	<i>Barriers to self-managing foot care, how addressing these can improve the quality of life and reduce the needs for podiatry services</i> Carol Mioduchowski*, Tina Loxley*
23	<i>Mmmmm-health - a tasty choice for consumer care</i> Jacqueline Nix
24	<i>It started as a good idea and grew into a wave of change</i> Kate Osborne *, Lyndel Santibanez, Tanya Lehmann
25	<i>Does religion have a place in hospitals?</i> Martin Prewer, David Glenister *
26	<i>Leading transformational change in quality systems through an Allied Health innovation framework</i> Rebecca Tyson
27	<i>Streamlining Allied Health led outpatient clinics in preparation for centralised access</i> Lucy Whelan, Raisa Shaikh, Gillian Butcher, Kerry May*
THEME Early Graduate Programs	
28	<i>Transition support program for allied health graduates - the how and the who</i> Lauren Muir *, Dr Karen Donald, Dr Ruth Nicholls, Dora Szucs
29	<i>Transition support program for Allied Health graduates - all together now!</i> Dr Ruth Nicholls *, Dr Karen Donald, Lauren Muir, Daniela Feuerlicht
30	<i>Presentation and evaluation of a multi-disciplinary graduate program for nursing, occupational and music therapy</i> Alice Parkhill *, Annelis Way *
31	<i>New graduate allied health in mental health - a workforce development programme</i> Suzanne Stubbs, Megan Owens *
THEME Education / Academics	
32	<i>Allied Health: Tracing the meaning of the term</i> Martin Chadwick

33	<i>Improving workplace education efficiency and quality- evaluation of an Allied Health practitioner education framework</i> Janet Golder *, Sam Sevenhuysen, Melanie Farli
34	<i>Clinical education model for the Acute Neurosciences Physiotherapy Team</i> Thao Nguyen
35	<i>Internationalisation of Australian health sciences curricula: A case study</i> Michael Storr *, Dr Sze-Ee Soh, Dr David Manallack, Kim Thompson, Geoffrey Hooke, A/Prof. Prue Morgan
THEME Education Issues	
36	<i>Design and implementation of a benchmarking process for determining comparability and predictability of clinical placement offers</i> Mark Gooding *, Kassie Shardlow
37	<i>Mapping Allied Health clinical education delivery across the spectrum</i> Kimberley Haines *, Robert LoPresti, Debbie Munro
38	<i>Addressing the challenges of student placement demand</i> Laura Morrison *, Liza-Jane McBride
THEME eHealth / Technology / Genomics	
39	<i>Affordable technologies for healthcare</i> Dr Angelo Basteris, Prof Michele Sterling
40	<i>Establishing the baseline - developing a consistent minimum data set for Allied Health in NSW</i> Steven Bowden *, Paula Caffrey, Georgina Frank, Lyn Biviano, Patricia Bradd, Bronwen Craig
41	<i>Can telehealth substitute review appointments by the advanced musculoskeletal physiotherapists working in the post arthroplasty review clinic?</i> Stephanie Carroll *, Catherine Senserrick *, Carolyn Page
42	<i>Efficacy of technology-aided speech therapy for the management of speech sound disorders: A review of the evidence</i> Lisa Furlong *, Prof. Meg Morris, Dr Shane Erickson

43	<i>Taking bytes of Allied Health - using information and technology to raise our profile</i> Rebecca George
44	<i>Telehealth capacity building in allied health services</i> Ilsa Nielsen *, Jayne Kirkpatrick, Peter Fuelling
45	<i>Development of an e-learning package for multidisciplinary clinicians on cancer malnutrition</i> Amber Kelaart, Lauren Muir*, Dr Karen McDonald
46	<i>Appetite for eLearning</i> Lauren Muir *, Amber Kelaart, Dr Karen Donald
47	<i>Developing a national allied health dataset</i> Catherine Stephens *, Jan Erven *, Mary Haire *
48	<i>Use of gaming technology in upper limb prosthetic rehabilitation</i> Michelle Wallace *, Marlina Klaic
THEME	Equity of Access (Indigenous, Growth Corridors, Populations at Risk)
49	<i>Outcomes evaluation of the Work It Out chronic disease self-management and rehabilitation program for Aboriginal and Torres Strait Islander people</i> Tabs Basit, Katrina Rae*, Emma Campbell, Samara Dargan, Alison Nelson
50	<i>Investigation of the effectiveness of nutrition intervention, in the management of malnutrition in colorectal patients receiving chemotherapy</i> Hollie Bevans *, Heather Jordan, Aurora Ottaway, Kathryn Pierce, Emily Karahalios
51	<i>Clinical and cultural governance - working hand in hand in a Kaupapa Mori healthcare organisation</i> Janice Mueller *, Taima Campbell, Ian Rowe
52	<i>Fighting disadvantage: Examining the role of social work in the context of an Aboriginal Sustained Home Visiting program</i> Kate O'Connor

THEME	Extended Scope of Practice (Science Disciplines)
53	<i>Dietitians as first contact practitioners for management of functional gut disorders</i> Jennifer Ellick *, Merrilyn Banks, Mark Appleyard
THEME	Extended Scope of Practice (Therapy Disciplines)
54	<i>Physiotherapy-led orthopaedic screening clinic: Analysis of 5,000 appointments</i> Caitlin Farmer *, Anton Harms, Robyn Coyne, Raphael Hau
55	<i>Developing the role of speech pathology in palliative & supportive care</i> Tom Gauci
56	<i>Lessons learnt from a complex, multistakeholder, online survey</i> Andrea Hurwood, Catherine Barrett *, Mark Minnery
57	<i>When training is not enough</i> Laura Morrison, Liza-Jane McBride *
58	<i>Development of a credentialing package to support the introduction of advanced practice occupational therapy driver assessor roles</i> Sharon Neale *, Kate Cranwell
59	<i>Discharged from outpatient care post-arthroplasty at 3 months without seeing an Orthopaedic Surgeon</i> David O'Keeffe *, Ton Tran, Brendon Zeman, Ali Gibbs
60	<i>Creating an Allied Health rural generalist model of care by implementing the Calderdale Framework using clinical re-design Methodology</i> A/Prof Alison Pighills
61	<i>Application of a single session framework in child development services: Advanced scope of practice for allied health clinicians</i> Jordana Rigby *, Jannie Leach *, Linda Barry *
62	<i>The factors that influence decision making: A overview for service providers</i> Dr Rachael Schmidt

63	<i>Ordering of blood tests by the advanced musculoskeletal physiotherapists at St Vincent's hospital Melbourne emergency department</i> Bridget Shaw *, Tom Collins
64	<i>Advanced practice in continence and women's health physiotherapy: A multi-site pilot</i> Dr Margaret Sherburn *, Sarah Clever, Jane Carlin, Hayley Irving, Sarah Lorentzen *, Fiona Brennan, Yvonne McNeel, Hannah Graetz
65	<i>The lumps and bumps of establishing a rural multidisciplinary paediatric feeding clinic</i> Wendy Swan, Tammy Phelps *
66	<i>Transdisciplinary practice: How can allied health identify and shape the potential and limitations?</i> Jessica Toohey
67	<i>Using simulation to educate transdisciplinary learners: An effective competency based education strategy?</i> Jessica Toohey
68	<i>'Smoking & You' - a unique occupational therapist & pharmacist co-facilitated inpatient education group in an acute mental health facility</i> Anna Treloar-Tanner *, Michelle Kent
THEME	Health Economics / Financial Sustainability
69	<i>Cost-effectiveness analysis - a novice's experience</i> Kristen Demedio, Adrienne Young, Edward Burn, Dr Merrilyn Banks, Dr Alison Mudge, Jenna Stonestreet*
70	<i>Advantages and challenges of providing weekend allied health services on acute medical and surgical wards: The managers' perspective</i> Deb Mitchell *, Dr Lisa O'Brien, A/Prof. Anne Bardoel, Prof. Terry Haines
71	<i>Physiotherapy volunteers in a sub-acute setting</i> Melissa Roberts, Anne Maree Cox, Katrina Angus, Little Cassy, Jane Livingston, Jane Carlin, Sarah Milne, Stuart Cavill*

72	<i>Now you're healed, let's get you heeled; footwear for the high-risk foot</i> Sonja Rogasch *, Jane McCann, A/Prof Paul Wraight
73	<i>Disinvestment research in high-risk clinical populations: Weekend allied health services to acute medical and surgical ward tracheostomy patients - "a pilot non-randomised controlled clinical trial"</i> Mitchell Sarkies *, Dr Kelly-Ann Bowles, Dr Elizabeth Skinner, Deb Mitchell, Romi Haas, Karen Salter, Melissa Ho, Prof. Terry Haines
THEME	Inter-Professional Practice
74	<i>Medication at any cost? Exploring the unique partnership between social work and pharmacy in a specialist cancer hospital</i> Denise Beovich *, Alison Hocking, Fiona Wiseman, Allan Shum, Sue Kirsas, Danni Mendonca
75	<i>Sexuality and stroke: Implementing the evidence to stroke survivors undergoing inpatient rehabilitation</i> Anita Brown-Major*, Dr Christine Cowan
76	<i>Allied health and MHPN - a growing connection</i> Chris Gibbs
77	<i>You are not alone: Client centred provision of information to patients on discharge from the acute and sub-acute setting</i> Louise Mogg
78	<i>How much do cancer care clinicians know about cancer malnutrition?</i> Lauren Muir, Amber Kelaart *
79	<i>Menu ordering systems: Exploring their impact on patient satisfaction with hospital foodservices</i> Ella Ottrey *, Dr Judi Porter
80	<i>Negative mealtime interruptions in hospitals: Findings of a series of observational studies</i> Dr Judi Porter *, Anita Wilton, Jorja Collins

81	<i>Issues in addressing psychological wellbeing and depression in people with aphasia: Need for inter-professional practice</i> A/Prof Miranda Rose *, Caroline Baker, Jasvinder Sekhon, Dr Marcella Carragher, Dr Kyla Brown, Dr Brooke Ryan, Prof. Jacinta Douglas, Prof. Linda Worrall, Prof. Ian Kneebone
82	<i>Service provision for post-stroke aphasia in acute and sub-acute settings: Solutions for addressing the evidence-practice gaps</i> A/Prof Miranda Rose *, Abby Foster, John Pierce, Maya Menahemi-Falkov, Jasvinder Sekhon, Dr Shane Erickson, Dr Annie Hill, Dr Robyn O'Halloran, Prof. Linda Worrall
83	<i>Every patient ... every interaction ... every time. Redefining the therapeutic principle to maximise inter-professional practice & patient outcomes</i> Christine Stone *, Ann Yeomanson, Damian Gibney
84	<i>Interdisciplinary Allied Health advanced practice pilot in general medicine; phase one</i> Dina Watterson *, Indi Swan, Desiree Terrill, Lisa Somerville, Lyndell Keating, Kathleen Phillip
THEME Knowledge Transfer	
85	<i>An educational play therapy intervention, deconstructed</i> Amber Hill
86	<i>Sustaining evidence in clinical practice: Introducing Functional Electrical Stimulation (FES) across a large tertiary hospital</i> Brittni Nielsen *, Marlena Klaic
87	<i>Establishing social work bereavement practice in an acute oncology specialist hospital</i> Alison Hocking, Kathryn Turner
THEME Models of Care (Multi-disciplinary)	
88	<i>Understanding consumer and clinician preferences for inpatient rehabilitation after joint arthroplasty</i> Mark Buhagiar *, Dr Justine Naylor, Dr Grahame Simpson, Prof. Ian Harris, A/Prof. Friedbert Kohler

89	<i>Kooyong multidisciplinary low vision clinic: An optometry perspective</i> Mae Chong *, Dr Jonathan Jackson, Gay Hickey, A/Prof. Sharon Bentley
90	<i>Streamlining access to falls and balance services</i> Luke Cosgrave *, Rosaria Iannelli, Sue Hull, Nicky Tully
91	<i>On the right track: Peter Macs response to optimising cancer care for older patients</i> Jackie D'Abaco *, Tegan Murnane *
92	<i>Centralised triage of spinal referrals - a model for establishing consensus and directing patients to more appropriate timely care</i> Adam de Gruchy *, Uyen Phan, Tanya Yuen, John Cunningham, Prof. Danny Liew, Prof. Ian Wicks, Dr John Moi
93	<i>Back pain Assessment Clinic: The feasibility and effectiveness of a primary care-based, physiotherapy-led spinal service</i> Adam de Gruchy *, Uyen Phan, John Cunningham, Tanya Yuen, Prof. Ian Wicks, Dr John Moi
94	<i>Defining Allied Health interventions in palliative care</i> Jenny Downes, Edite Tang, Mark Buhagiar *, Abdul Shaik
95	<i>One size does not fit all - reviewing the Pain Management Service at Broadmeadows Health Service</i> Helen Easterby *, Michelle Stillman *
96	<i>Development of an innovative and comprehensive allied health program in an adult mental health extended care unit</i> Jillian Ensor *, Jaye Thompson *, Jude Hewavasam, Jacqui Whitehead
97	<i>Service provider perspectives for optimising system interfaces within the Geriatric Evaluation and Management (GEM) model of care</i> Dr Desley Harvey *, A/Prof. Michele Foster, Rachel Quigley, A/Prof. Edward Strivens
98	<i>Optimal cancer care pathways: Achievements and future directions</i> Alison Hocking *, Alexandra Philpott, Prof. Robert Thomas, Kathryn Whitfield

99	<i>Evaluation of the implementation of a Tracheostomy Review Service (TRS) - do all get the same positive outcomes?</i> Clare Holdsworth *, Louise Malcolm *, Dr Anne Marie Southcott, Dr Elizabeth Skinner, Dr Sanjeevan Muruganandan
100	<i>Illuminating redesign through shadowing</i> Glenda Kerridge *, Jo Gatehouse, Damian Gibney, Geraldine Millard, Ann Yeomanson
101	<i>The effectiveness of a volunteer meal assistance program to improve the nutritional intake of aged care patients in hospital</i> Allison Lauder *, Hollie Bevans, Kathryn Pierce, Aranka Nenov
102	<i>Better together: An allied health led 'one stop shop' for falls prevention</i> Brooke Lee *, Neo Damba *
103	<i>Meet Your Feet: A person centred multidisciplinary self-management health education program</i> Tina Loxley
104	<i>Top to toe</i> Kim Manderson *, Katie Van Der Kraan *, Priscilla Hedger *, Jo McEllinny *
105	<i>Putting our best feet forward - A collaborative approach to healthy feet</i> Kathleen McClintock *, Jo Richie, Andrew Nashed, Sarah Parks, Melissa Mair
106	<i>Complex regional pain syndrome: A new model of care improving patient outcomes</i> Zoe Milner*, Hayley O'Sullivan
107	<i>An e-health approach to improving diabetic foot screening and reducing amputations for people in rural South Australia</i> Fiona Murray *, Rosy Tirimacco
108	<i>The structured rollout of negative pressure wound therapy across community health services in country South Australia</i> Fiona Murray
109	<i>Multidisciplinary diabetes eye care services through the Australian College of Optometry</i> Leanne Nguyen *, Dr Genevieve Napper, A/Prof. Sharon Bentley

110	<i>Interdisciplinary management for malnutrition in hospital</i> Kathryn Pierce *, Allison Lauder, Aranka Nenov, Hollie Bevans
111	<i>Preliminary data demonstrating the impact of an ENT allied health practitioner service on ENT waiting lists at Logan Hospital</i> Marnie Seabrook *, Sally-Ann Schilt, Prof. Liz Ward, Dr Bernard Whitfield
112	<i>Supporting high quality nutrition care with a malnutrition governance toolkit</i> Natalie Simmance *, Rebecca McIntosh
113	<i>What are the benefits of an allied health team in an Emergency Department?</i> Cathie Smith *, A/Prof. Lou Harms *
114	<i>Rural Pilot Falls Prevention Program</i> Meaghan Sully *, Neræe Anstee
115	<i>Close the Wait Strategy: A dynamic approach to wait list management</i> Kathryn Witt *, Paula Hennessy
THEME Models of Care (Multi-Morbidity)	
116	<i>Generalized outpatient rehabilitation program compared to usual care on functional exercise tolerance in people with multimorbidity: a pilot randomized controlled trial</i> Kathryn Barker *, Kathryn Ritchie, Annemarie Lee, Anne Holland, Terry Haines, Monica Turczyniak, Lee Thomas, Claire Boote, Fiona Pazsa, Elizabeth Skinner
117	<i>Does eating environment have an effect on the intake in the elderly</i> Aranka Nenov, Karon Markovski, Aurora Ottaway*, Elizabeth Skinner
118	<i>Aquatic physiotherapy management of an elderly orthopaedic patient with obesity</i> Catherine O'Brien
119	<i>Frontline and patient centred: Orthopaedic Screening in Primary care (OSiP)</i> David Smith *, Maree Raymer

120	<i>Life after stroke: Peer support program</i> David Towl, Ayesha Ghosh*, Sonia Thomas, Bronwyn Davies, Fiona McKinnon
THEME	Prescribing
121	<i>Can we do better? Consolidating consumer involvement in therapeutic practice</i> Rebekah Cranmer *, Janelle Johanson *
122	<i>Use of a Decision Support Software (Guidance MS) to guide prescribing of new oral anticoagulants (NOAC)</i> Vinod Chellaram *, Ameeta Chhanabhai, Dr Lachlan Hayes, Dr Prahlad Ho
123	<i>Pharmacist prescribing in the UK: Can we apply a similar model to Australia?</i> Kyrillos Guirguis
THEME	Professional Development / Skill Building (Clinical / Advanced Practice)
124	<i>Building expertise in Allied Health</i> Carmel Blayden
125	<i>Development of paediatric physiotherapy acute care competencies</i> Elizabeth Dalla Santa, Clare McKinnon*, Dr Ruth Nicholls, A/ Prof. Bev Eldridge*
126	<i>An approach to hoarding disorder for Allied Health professionals working in the community</i> Leah Hewitt
127	<i>The speech pathology workforce in remote areas of Australia</i> Nanthini Kanthan *, Prof. Dean Carson
128	<i>Investing in our staff</i> Leonie Pearce, Kate Desneves, Sofie Modulon*, Fiona Sammut
129	<i>Emergency Department patients with complex health and social needs: what do social workers do?</i> Carol Quayle *, Annabel Henderson, A/Prof. Fiona McDermott

130	<i>Critical appraisal skills should be front and centre of workforce development agendas? A pseudo-experimental before and after study</i> Jenna Stonestreet *, Jack Bell
131	<i>We've got SWAGER (Social Work and Groups Enhancing Rehabilitation)</i> Melanie Wells *, Lisa Bloomfield *, Angela Whelan *
THEME	Professional Development / Skill Building (Communications with Consumers)
132	<i>Interventions and outcomes - what are social work documenting at Western Health?</i> Anne Ingram *, Teresa Grant, Cathy Dow *
133	<i>Allied Health and community services negotiation skills and influencing behaviours training</i> Natasha Toohey, Ms Gabriela Veliz *, Ms Linda Betts
134	<i>The Allied Health educator & data manager: Using data to facilitate service delivery & patient outcomes</i> Matthew Webb
THEME	Research and Quality Improvement
135	<i>AH RAPID: Allied Health Rapid Assist Promoting Immediate Discharge - provision of equipment on acute medical wards to facilitate patient flow at a regional hospital</i> Katie Arnott *, Cate Carter
136	<i>Measuring the research culture of allied health at Bendigo Health</i> Donna Borkowski *, Dr Carol McKinstry, Dr Matthew Cotchett
137	<i>Fasting audit in orthopaedic and orthogeriatric unit patients</i> Caroline Calkin *, Vanessa Carter, Kathryn Pierce, Irene Deftereos
138	<i>High level care discharges: A review of occupational therapists confidence and understanding</i> Elizabeth Castles, Bianca Furmston, Rebekah Clutterbuck, Anita Suon *, Dr Louise Corben

139	<i>Investigation of current Australian physiotherapy service provision for extended stay antenatal inpatients</i> Lauren Clarke *, Elise Fraser, Tanya Darrer
140	<i>Qualitative and quantitative study of hoarding and squalor clients in the Western Region of Melbourne</i> Warren Fuge *, Jacinta Robertson *, James Morris, Elena Spasovska, Deborah Bailey, Dr Diana Perre, Dr Sook Meng Lee
141	<i>Reducing re-admissions within internal medicine services - the patients' perspective</i> Marissa Galler, Lauren Boisen, Paul Stephens*
142	<i>A pilot study investigating the dietetic weight loss interventions and 12 month functional outcomes of patients undergoing total joint replacement</i> Naomi Gandler, Natalie Simmance*, Dr Michelle Dowsey
143	<i>A collocated subacute amputee service reduced acute length of stay in Melbourne's Footscray Hospital</i> Catherine Giuliano *, Candice Poupard *, Hannah Furlong *, Catherine Davey, Melanie Reed, Euhin Koh, Lorinda Ndenzako, Dr Ngoc Le
144	<i>What are the barriers to implementation of the physical activity guidelines in lung cancer? A qualitative study involving expert clinicians</i> Dr Catherine Granger *, Prof. Linda Denehy, A/Prof. Louisa Remedios, Dr Selina Parry
145	<i>Patient and carer perspectives of transitions across acute, sub-acute and primary care</i> Dr Desley Harvey *, A/Prof. Michele Foster, Rachel Quigley, A/Prof. Edward Strivens
146	<i>Hospital presentations of the homeless: Social work initiatives in quality improvement</i> Bobbi Henao Urrego
147	<i>Lessons in developing a national collaborative research agenda in oncology social work</i> Alison Hocking *, Kim Hobbs, Dr Rosalie Pockett, Prof. Lynette Joubert

148	<i>A pilot study comparing two different methods of goal setting in home based stroke rehabilitation</i> Emily Hogan
149	<i>Outcome measures: Integrating their use in clinical decision making and client centred goal setting</i> Alison Johnson *, Hilarie Tardif
150	<i>Assessing the reliability and validity of a physiotherapy functional measurement tool, the modified Iowa Level of Assistance scale, in acute hospital inpatients</i> Lara Kimmel, Jane Elliott *, James Sayer, A/Prof. Anne Holland
151	<i>Developing the validated Foot-care abilities questionnaire (F-CAQ), using quality improvement outcomes</i> Tina Loxley
152	<i>Utility of the Managing Well Neuro' Checklist: Pilot study of a novel clinical tool for people with long-term neurological conditions</i> Lisa Majteles *, Sharon Lawrie, Jenna Von Carate, Prof. Barbara Singer, Susan Alexander
153	<i>Sexuality after stroke - not only a challenge for occupational therapy</i> Sarah Murphy
154	<i>Managing the load: The impact of redesign principles on community health occupational therapy waiting times</i> Clare O'Brien, Emily West*, Belinda Brookes
155	<i>Piloting the use of an I-Pad by social workers and clients in community therapy services; home based settings</i> Tanaya Poupard
156	<i>The impact of providing additional Saturday therapy on self care and participation</i> Camilla Radia-George *, Prof. Nicholas Taylor, Kylee Lockwood, Natasha Brusco, Casey Peiris, Prof. Nora Shields

157	<i>Do discharge plans for patients undergoing rehabilitation meet their requirements? An observational study</i> Kate Roberts *, Rachel Dempsey, Amanda Wurfel, Justin Andrews, Kathy Stilller
158	<i>When is the right time for allied health intervention. A review of children in Out of Home Care requiring intervention</i> Elizabeth Scerri *, Lisa McCue *
159	<i>Malnutrition prevalence in oncology patients over time - a regional experience</i> Wendy Swan *, Deanna Cook
160	<i>Self-reported motivators, barriers and abilities of allied health teams to undertake research: Is there a link with actual research output?</i> Dr Rachel Wenke *, Prof. Sharon Mickan
161	<i>Multidisciplinary care of cardiac surgery patients - a key element of a service aiming to optimise the patient experience at Gold Coast University Hospital</i> Katie Williams *, Nicole Rampton, Michelle Jeffress, Jennifer Winstanley, Katherine Dunn, Amanda Butler, Penny Schofield
THEME	Rural Health
162	<i>Delivering multi-disciplinary cardiac rehabilitation in the bush: The Wimmera Hub & Spoke telehealth model, improving access for rural people</i> Annabel Askin, Pam Marshman*, Donna Bridge
163	<i>Allied health students' perceptions of metropolitan versus rural clinical rotations</i> Greg Mundy *, Jo-anne Chapman, Anthony Wall
164	<i>Exploring the issues for regional therapists in professional development and clinical management of neurological patients in Victoria</i> Jan Quiney *, Thao Nguyen, Samantha Plumb, Marlena Klaic
165	<i>Virtual Fracture Clinic</i> Jenny Wheeler

166	<i>Chest trauma management at a regional health service - is physiotherapy front and centre?</i> Dr Brooke Winzer
THEME	Simulation Based Learning
167	<i>Making it SIMPLE: Simulation In Multiple interProfessional Learning Environments</i> Carol Jewell *, Alex Gorelik, A/Prof. Peter Morley
168	<i>Simulation in a novel environment: An interdisciplinary pool rescue</i> Debra Virtue *, Elizabeth Villalta, Carolyn Page, Dr Stuart Dilley, Kirsten Murtagh
169	<i>Measuring the impact and responsiveness of the expanding SLIPAH (Simulated Learning in Paediatrics for Allied Health) Program across Queensland</i> Sarah Wright *, Lisa Findlay, Sarah Goodman, Rachel Thomas, Kristine Kelly
THEME	Student / Graduate Projects
170	<i>A clinical educator directed collaborative learning model for dietetic students</i> Tracie McRorie *, Kate Desneves, Leonie Pearce, Tobi Erickson, Sofie Modulon, Sonia Brockington
THEME	Workforce Development
171	<i>Partnerships and points of difference - opportunities for primary and tertiary health services in Victoria</i> Catherine Austin
172	<i>Positive team culture: The importance of listening to your team</i> Jacinta Baker
173	<i>Exercise physiologist perceptions of work setting, professional status and career pathways</i> Robert Barnard *, Barry Couzner
174	<i>From bedside to boards: Allied health leadership</i> Dr Rosalie Boyce *, Dr Paul Jackway

175	<i>Analysis of the Australian orthotist/prosthetist workforce 2007-12</i> Leigh Clarke *, Dr Emily Ridgewell, Dr Michael Dillon, Jackie O'Connor, Sarah Anderson
176	<i>Future proofing the allied health workforce; a South Island regional approach</i> Sandy Clemett *, Catherine Coups *
177	<i>Developing leadership capability through Allied Health ward facilitator roles</i> Talya Cortinovis, Susan Pike*, Emma Beer
178	<i>Review of the Monash Health grade one physiotherapy rotation model</i> Sarah Davenport
179	<i>Paediatric physiotherapy training program - The Royal Childrens Hospital Melbourne</i> A/Prof Beverly Eldridge *, Liz Dalla Santa
180	<i>The development of Allied Health research excellence in Australian tertiary hospitals: An initiative of St Vincent's Health Network, Sydney</i> Prof. Vicki Flood, Dr Josephine Gwynn*, Margaret Lazar
181	<i>Implementing a competency framework for supervisors of learners in a clinical environment</i> Anita Hill , Emma Scott*
182	<i>Reaching for the stars - a social work development and leadership program</i> Alison Hocking *, Bridget Wall *, Tass Kostopoulos, Debra Leahy, Sonia Posenelli, Georgina Hanna, Robyn Clark, Penelope Vye, Lisa Braddy, Julia Blackshaw
183	<i>Student supervisor skills development program</i> Tracie McRorie *, Leonie Pearce
184	<i>Strong and modern: Allied Health clinical services</i> Prof. Sharon Mickan *, Laura Eby

185	<i>Establishing an innovative Allied Health workforce planning blueprint to ensure best care and plan for tomorrow's workforce today</i> Claire Moody *, Natasha Toohey, Gaby Veliz
186	<i>Credentialling, competency and capability in allied health: An interim evaluation of the development and implementation of a state-wide framework</i> Andrea Pearce *, Kathleen Philip, Donna Markham, Jill Walsh, Sam Sevenhuysen, Michael Splawa-Neyman, David Lescai, Cylie Williams
187	<i>Allied Health workplace Learning: Developing the professions</i> Jane Porter *, Lisa Majteles
188	<i>What do we want? Transition to professional practice support for early career Allied Health staff. When do we want it? Now</i> Kathy Relihan *, Tanya Lehmann *
189	<i>Changing team dynamics through the use of the Team Management System</i> Julie-Anne Ross *, Ruth Cox *, Angela Wood, Sarah Bailey
190	<i>Allied health staff front and centre in contributing to better patient outcomes through an inter-professional capability development framework</i> Julie-Anne Ross *, Ruth Cox *, Angela Wood
191	<i>National Safety and Quality Healthcare Service Standards: Front and centre in student and staff orientation</i> Julie-Anne Ross *, Cate Fitzgerald
192	<i>Developing a physiotherapy competency framework</i> Rodney Sturt *, Paula Harding
193	<i>The current state of advanced practice in allied health in Victoria</i> Christie Van Beek, Jane Carlin, Mathew Jenkins *

EXHIBITORS

Site #	Organisation
1	Medico Insurance Services
2	Arthritis and Osteoporosis Victoria
3	Healthcare Australia
4	Southern Cross University Online
5	La Trobe University
6	Department of Health and Human Services (Victoria)
7	PCETC
8	HETI
9	Smith & Nephew
11	HESTA
12	Telstra Health
13	HICAPS
14	Australian Healthcare and Hospitals Association

Site #	Organisation
15	Victorian Allied Health Professionals Association
16	Department of Veterans' Affairs
17	Rural Health Professionals Program
19	James Cook University
20	NEHTA
21	Rural Health Workforce Australia
22	HSU National
24	Deakin University
25	Maida Learning
27	Health Workforce Queensland
28	Rocktape and Posture Medic

EXHIBITION FLOORPLAN

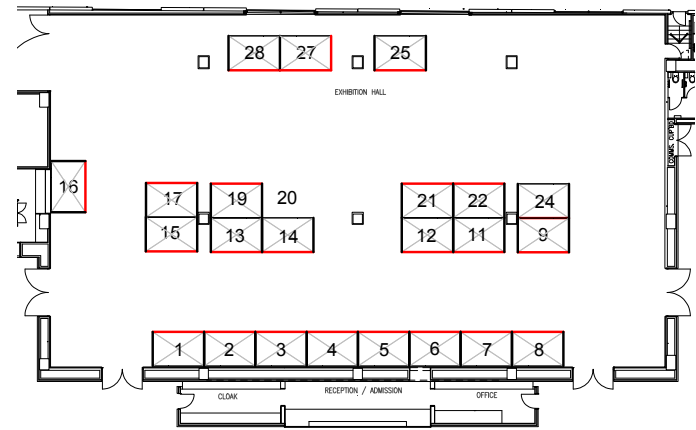

DOWNLOAD THE APP!

We strongly encourage all attendees to download the Delegate App to enhance your experience at the Conference.

Don't forget to vote for your favourite ePoster on the App. One lucky voter will win a great prize!



1. Download the 'Conference Design' App from the **Apple Store or Android Play Store.**
2. Open the App. Click on 'Download Guides'
3. Select the NAHC guide
4. Explore!

PLAY THE APP GAME

PRIZES TO BE WON!

visit the exhibitors to reveal the **SECRET PHRASE.**

Open the App Game in the Delegate App and **scan the QR Codes** you find with your smart device. Each QR Code reveals a portion of the **secret phrase.** Once you have revealed the phrase take it to the registration desk to go in the draw for great prizes!

Winners will be drawn during the closing session so complete the game before then to be in the draw.

You will need to be present in the session to win!



FREE WIRELESS

Username: QLD_HEALTH1

Password: b8Me34

OR

Connect to 'Crown Free Wireless' network

No username or password required

Just 'Agree' to the terms and conditions when the window pops up

Ground Level – Registration and Exhibition

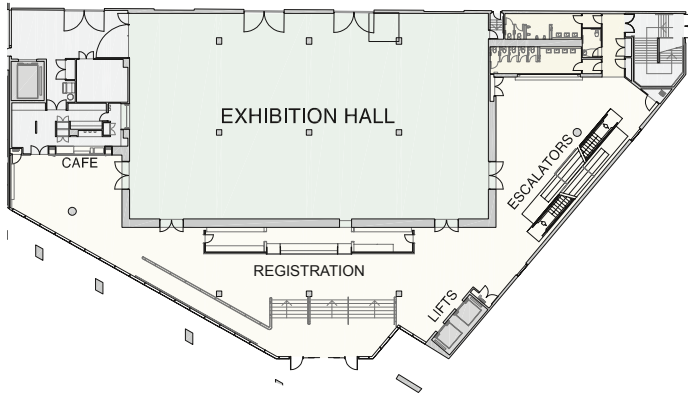

Level 1 – Breakouts

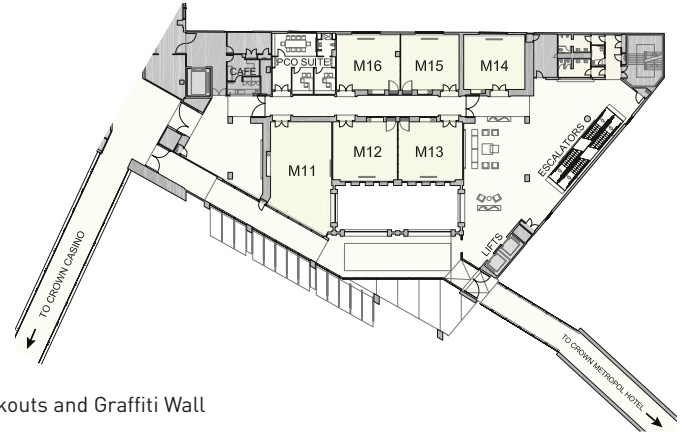

Level 2 – Plenary Sessions, Breakouts and Graffiti Wall

